

Tape Corner

06

R3



QUICK OVERVIEW: STRENGTHS

The best one for angular conjunctions

- Single-sided acrylic tape
- Pre-folded and partly devoid of the liner to facilitate the laying
- Acrylic glue, with high adhesion on all surfaces
- Dual use, internal and exterior, thanks to the waterproof surface

Features:

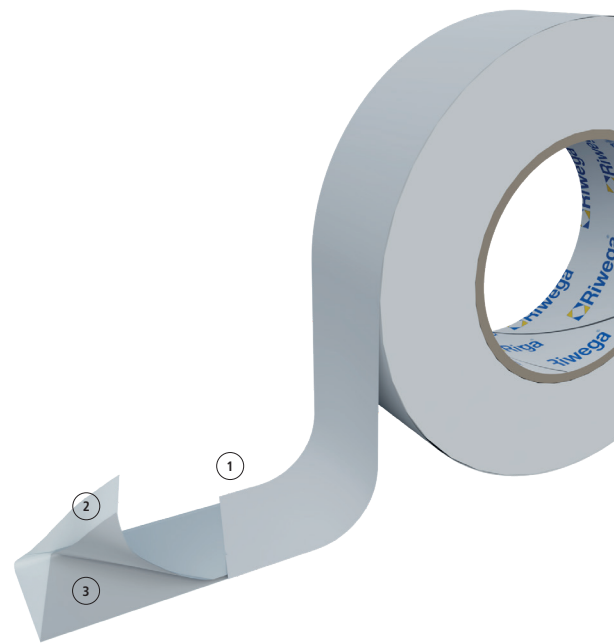

Technical data sheet

Glue		polyacrylate-based disp.
Glue carrier material		LDPE film
Reinforcing mesh		NO
Protection liner		PARTIAL
Solvents and emollients		NO
Sd value		~0,5 m
Working temperature		≥+0°C
Temperature resistance		-40°C / +80°C
UV stability		4 months*
Storage place		dry, protected from UV rays, +18°C / +25°C
Storage period		max. 12 months

Composition:

- Silicone liner ①
- Acrylic glue ②
- Polyethylene ③

Codes and measures

Version	Code	Measures (mmxm)	Box (pc)	Pallet (box)
Tape Corner 30/30	02040191	30+30x25	7	-
Tape Corner 12/48	02040192	12+48x25	5	-

Direct sales of Tape Corner only to Italy, Croatia, Slovenia, Estonia, Lithuania, Latvia, Finland, Portugal, Bulgaria, Switzerland, Greece, Romania, Slovakia, Turkey

*with reference to the Central European climate

Riwega Srl is not responsible for negligent and improper use of its products